

7-ROW MOBILE BLEACHERS FOR SALE

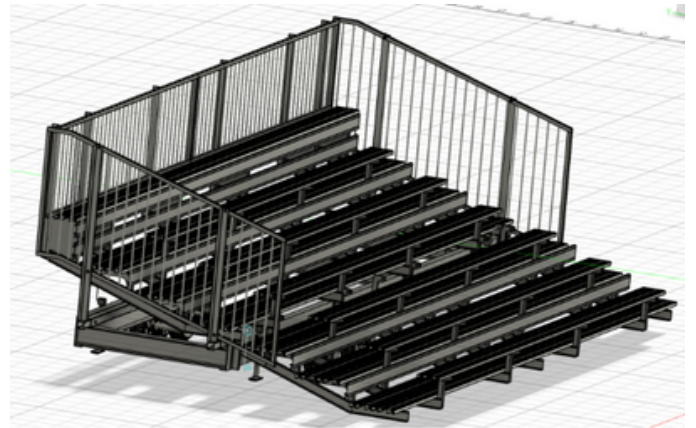

Highlights:

- More accessible with multiple stairs and handrails
- Easily connect multiple bleachers together for a seamless bleacher in minutes
- One person set up in 5 minutes.
- Lightweight and built to last (aluminum bleacher with galvanized steel frame)
- Building and fire code approved for indoor and outdoor use
- DOT and CVOR compliant, built for highway hauling

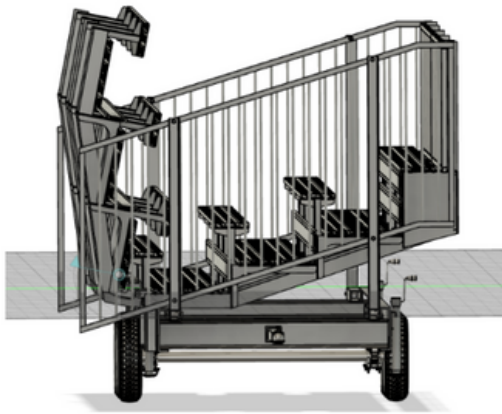

Mobile Bleacher Specifications

BR-7-100 / BR-7-200

Spec sheet	Weight	length	width	Height
T7-100 (trailer)	4000 lbs	28' including hitch	8' trailer width	110" tall on back rail
T7-100 (bleacher)	Max load 22,000 lbs	25', 20' of seating	14' front row to back rail	66" tall on back seat
T7-200 (trailer)	7000 lbs	53' including hitch	8' trailer width	110" tall on back rail
T7-200 (bleacher)	Max load 44,000 lbs	49', 40' of seating	14' front row to back rail	66" tall on back seat

Simple

- Designed to be setup with 1 person (5 minutes)
- Easy locking mechanism for folding sections
- All support jacks lower from backside on setup

Safe

- Meets all IBC and OBC requirements
- Vertical spindles on back and side rails to avoid climbing
- Stairs with handrails located on both sides

State of the Art

- Removable side rails to allow connecting multiple bleachers together
- Tandem suspension with electric braking system
- Highway towable - designed to meet DOT and CVOR requirements

Long lasting

- Galvanized steel frame
- Anodized aluminum seat boards
- Countersunk aluminum spindles to avoid cracking
- Simplified hinge & locking mechanisms

25 Foot: \$56,000 CAD

50 Foot: \$94,000 CAD

BR-7-100 / BR-7-200 Additional features

- Lockable control box
- Wireless hydraulic remotes
- Removable hitch
- Electric automatic leveling system
- Solar battery charging system
- Truck battery charging system
- Anti-slip and glow tape on steps
- LED lighting package on steps available (additional cost)
- Back rail banner / flag mounts
- Double mill finish footboards for improved traction
- Enclosed riser boards (no gaps over 4")
- Concealed hinge design
- Vertical spindles, less than 4" apart
- Anodized seat boards (keeps seats cooler in sun, prevents black marks)
- Customized end caps (cleaner look, no sharp ends)
- Jacks are all drill-operated from the back side for easier access
- All aluminum structure: lightweight and long lasting
- Uniform 8" rise and 24" run
- Meets fire code for indoor events
- Designed by engineers, with P.Eng stamp of approval.

To order:

800-436-0416

sales@BleacherRentals.com

